

Gaming Table-Agro Table



Power Input  
100V-240V



Speed  
25 mm/s



Motion Noise  
<55dB



Load Capability  
176 lbs / 80 kg



Overload  
Protection



Operation Temperature  
-20°C—+50°C



Thermal  
Protection



IP Grade  
IP20

## COMPONENT LIST

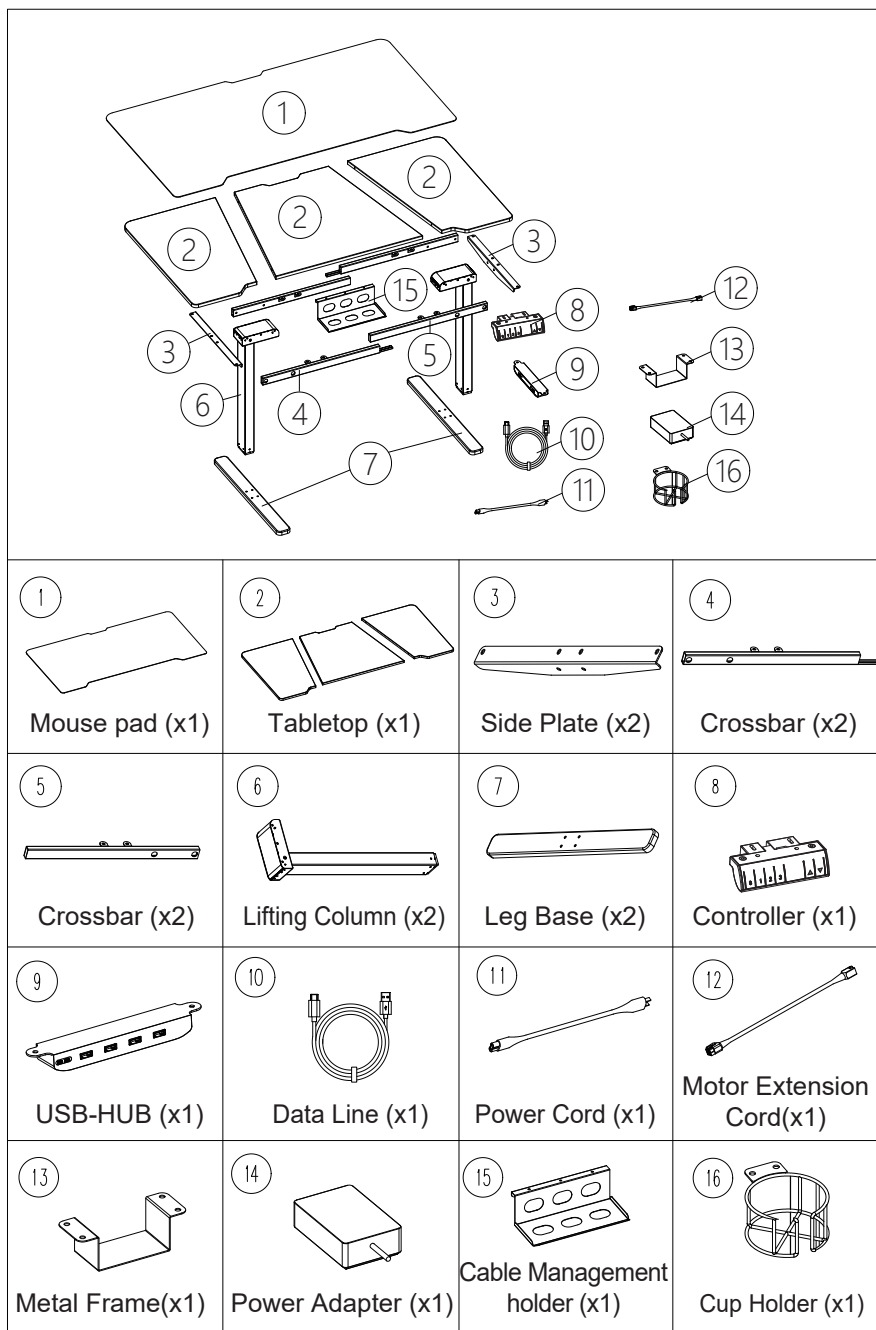

## Using the Controller

	Short-press the  button, and the display will flash. Press the , , or  button to save the current height setting to that button.
	Press the  button, and the desk will move to the height that was previously set for that button.
	Press the  button, and the desk will move to the height that was previously set for that button.
	Press the  button, and the desk will move to the height that was previously set for that button.
	Press the  button to raise the desk continuously until it reaches the highest position of 47.2" (120cm) or the button is released.
	Press the  button to lower the desk continuously until it reaches the lowest position of 28.3" (72cm) or the button is released.

Settings	
Change Display Height Units	Press and hold the  button until a flashing 'S'-is displayed. Press  again, and 'Un' is displayed. Press  or  to switch between 'IN'(imperial) and 'SI' (metric), and press  to save your choice.
Change Collision Detection Sensitivity	Press and hold the  button until a flashing 'S'-is displayed. Press  again, and 'Un' is displayed. Press  or  to switch to 'CF' and press  to select it. Press  or  to switch between off, low, normal, and high sensitivity. Press  to save your choice.
Reset	Press and hold the  button for 5 seconds, and the screen will show 'RES.' Continue holding until the desk goes down to its lowest level and comes back up slightly.

Protection Mode Error Codes	
Hot	Overheating Protection: When the motor has been working continuously for 2 minutes, it will stop operating to prevent damage from overheating. Wait for at least 18 minutes before making any further height adjustment.
E10	Sensor Malfunction Warning: Motor safety sensor can't be detected. Power off, check the connection between the motor and controller, and power back on again.
E20	Overloading Warning: Max load exceeded. If raising the desk, remove objects from the desk to reduce weight and try again. If lowering the desk, power off, take the things off the desk. Power back on, and try again.
E02	Operation Status Warning: The desk stops moving if vibration, impact, or incline are detected. If this detection is incorrect, follow the reset instructions before continuing use.
E32	Overvoltage Protection: Input voltage too high. If the correct AC adapter is being used, power off the desk, check the connection between power and the controller, and power on again.
E31	Undervoltage Protection: Input voltage too low. If the correct AC adapter is being used, power off the desk, check the connection between power and the controller, and power on again.
E60	Unequal Leg Height Warning: Power off the desk and check whether the left and right legs are at the same height. Power on again and adjust if necessary by following the "RESET" instructions.
-	Cable Disconnection Warning: Check motor and controller cable connections. Normal operation should return once all connectors are properly connected.

## Step 11

Put on the mouse pad, plug the power adapter cable into a power outlet to start adjusting the desk.

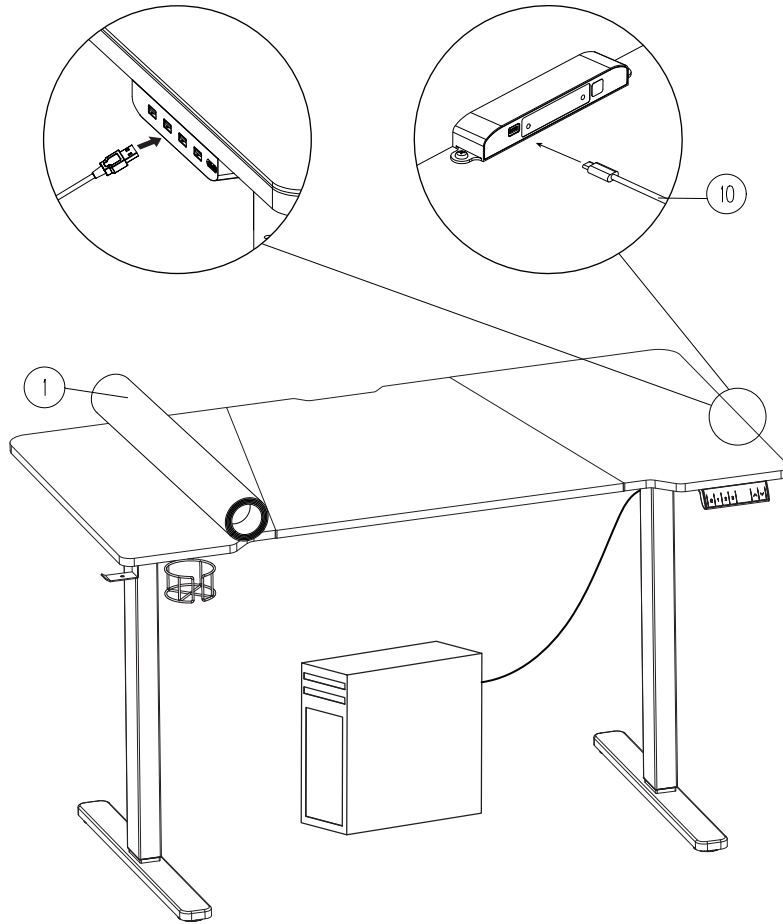

## HARDWARE LIST

A



Screws  
M6×12mm (x24)

B

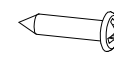

Screws  
M3.5×19mm (x2)

C

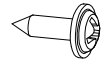

Screws  
M5×15mm (x44)

D



Allen Key  
S=4mm (x1)

E



Cable Clip (x5)

F



Rubber Pad (x16)

G

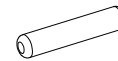

Wooden Pins (x4)

H



Connect part (x4)

I

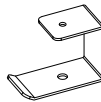

Headset Hook (x1)

## Spare Parts



A

M6×12mm (x2)



B

M3.5×19mm (x1)



C

M5×15mm (x2)



F



Rubber Pad (x2)



G



Wooden Pin (x1)

## Step 1

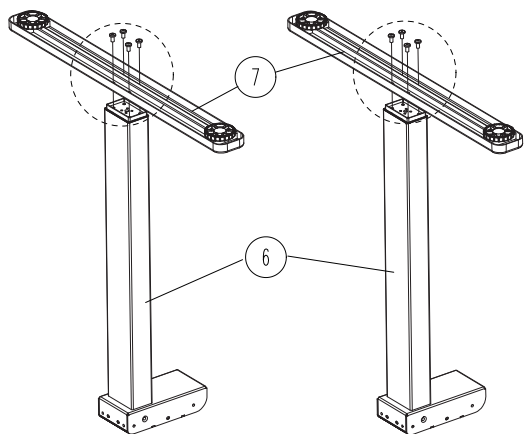
A	 M6×12mm(x8)
D	 S=4mm



## Step 2

A	 M6×12mm(x8)
D	 S=4mm

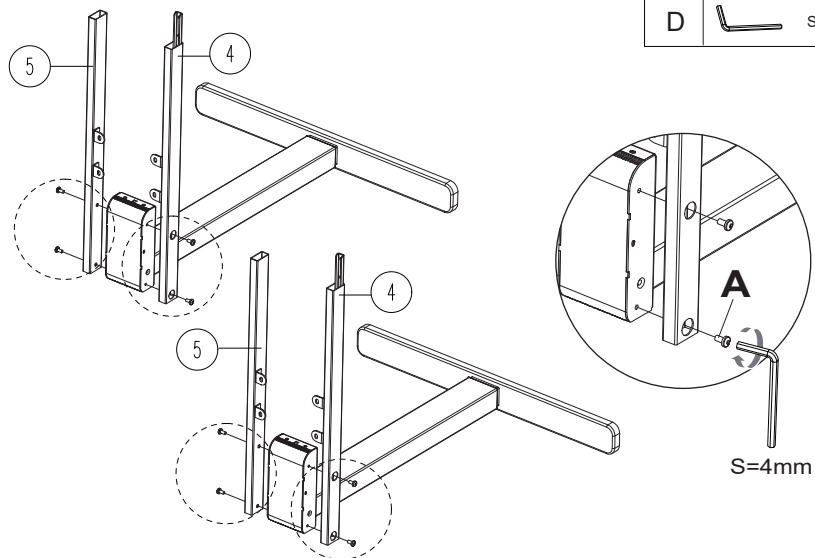

## Step 10

E	 Cable Clip (x5)
---	---

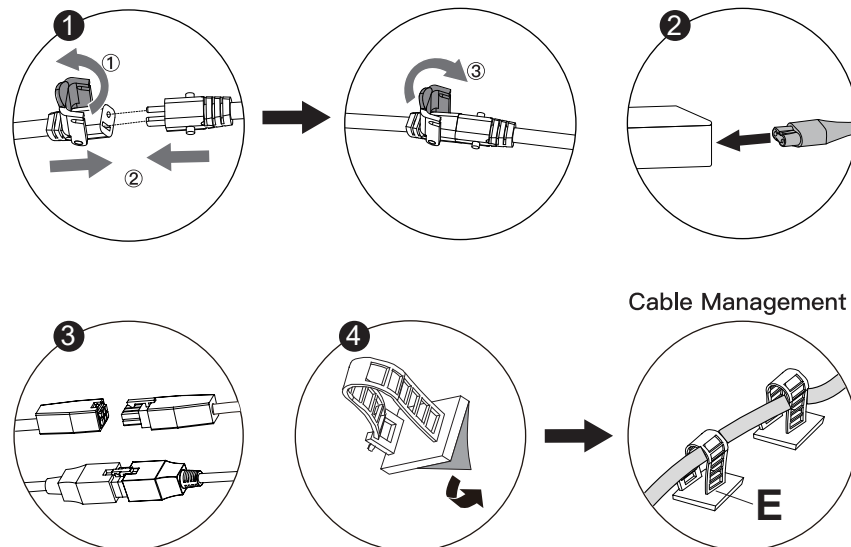
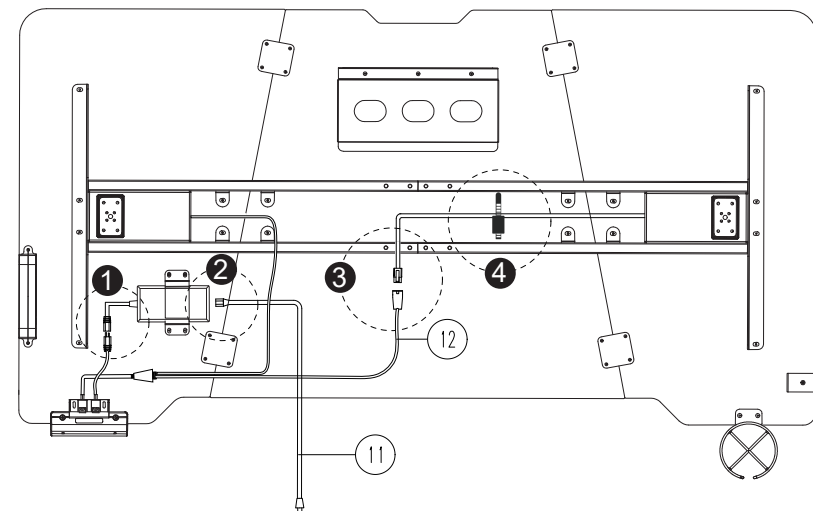

### Step 9

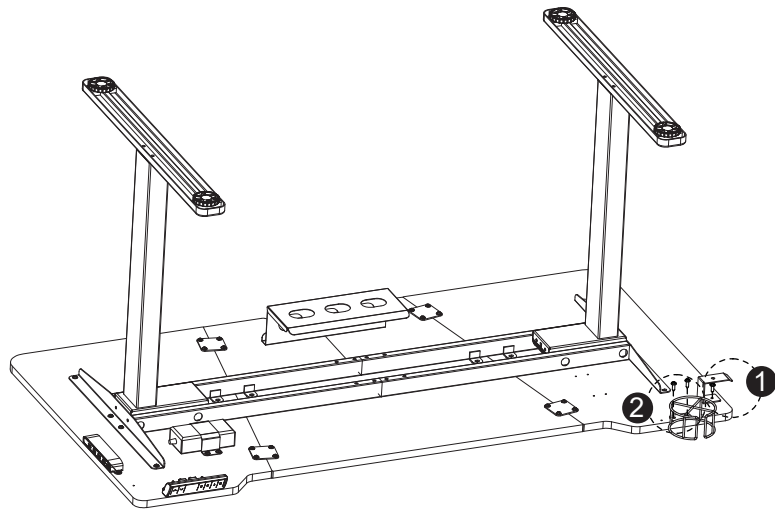
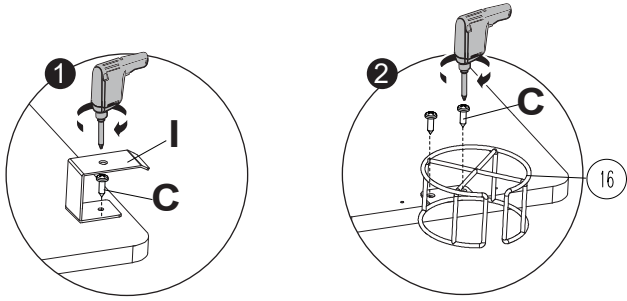
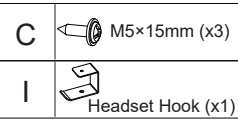

Different position could be choised for cup holder and headset hook.

### Step 3

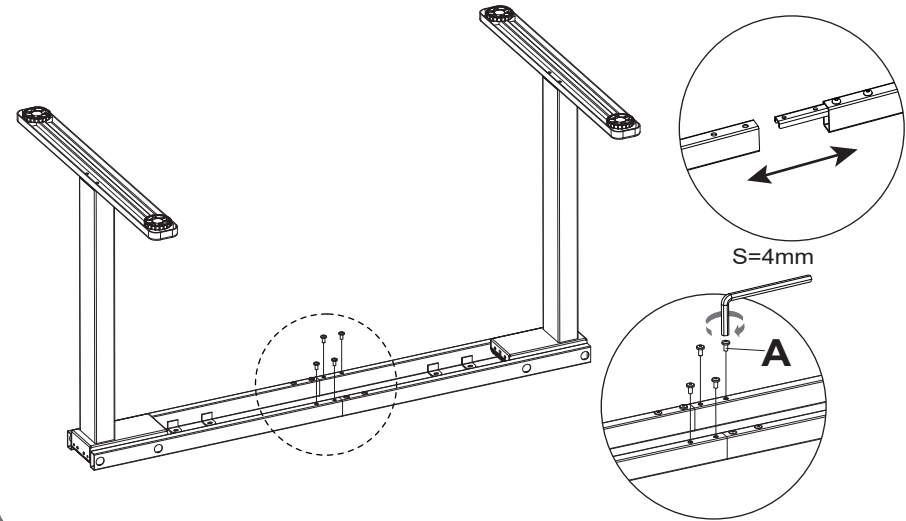
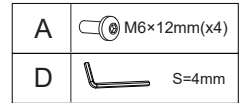

### Step 4

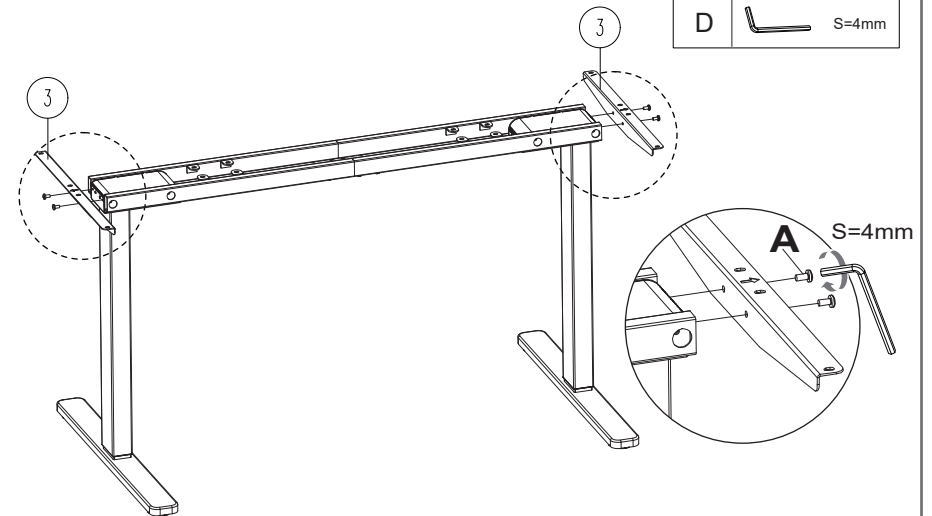
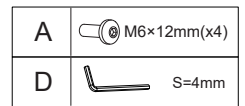

### Step 5

**F** Rubber Pad (x16)

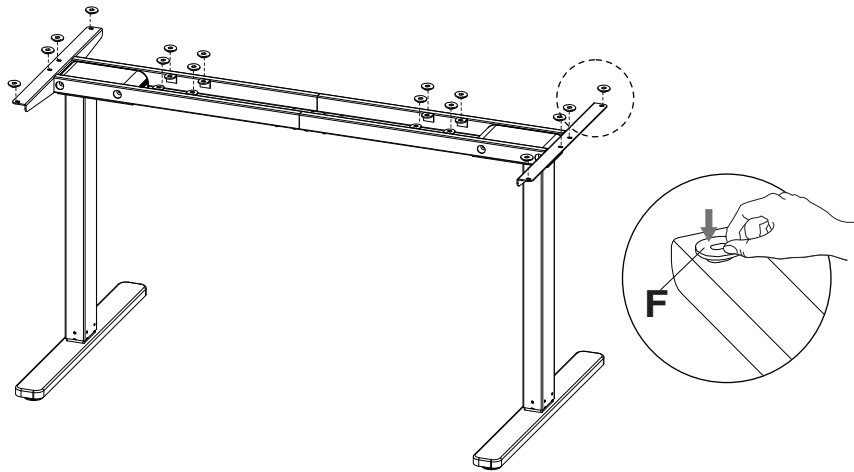

### Step 7

Pistol Drill  
(not included)

**C** M5×15mm (x19)

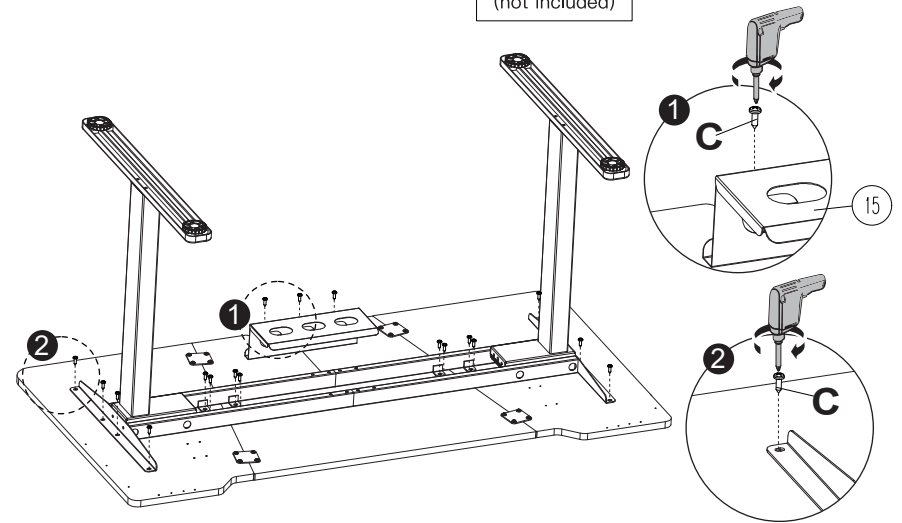

### Step 6

Pistol Drill  
(not included)

**C** M5×15mm (x16)

**G** Wooden Pins (x4)

**H** Connect part (x4)

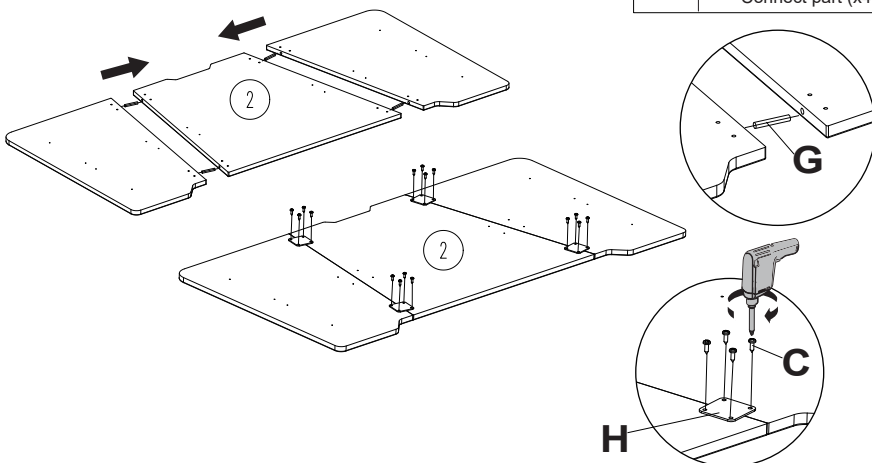

### Step 8

Pistol Drill  
(not included)

**B** M3.5×19mm (x2)

**C** M5×15mm (x6)

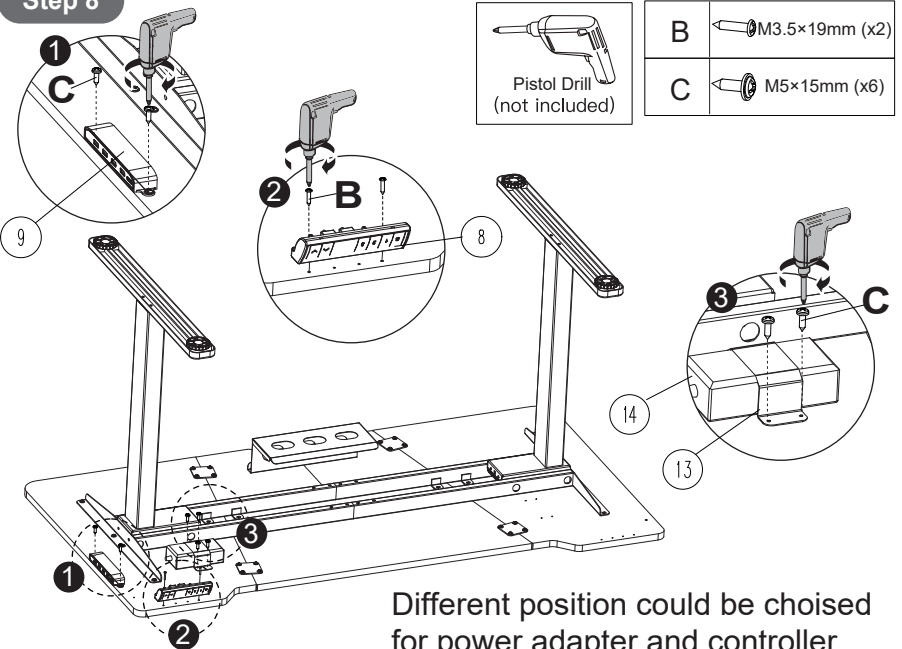

Different position could be choised for power adapter and controller.