

7

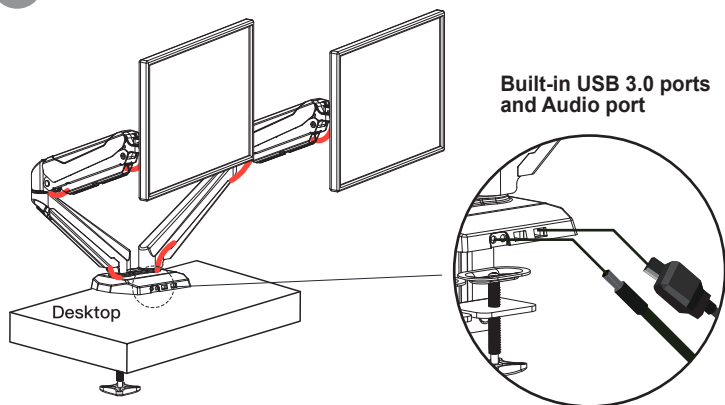

Leave enough slack in the cables at arm joints for full adjustment.

Gas Spring Aluminum LCD Monitor Desk Mount



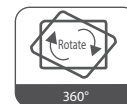
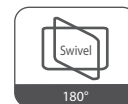
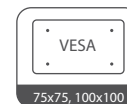
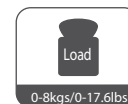
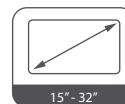

DEVO



Installation *INSTRUCTIONS*

WARNING STATEMENTS

Warning

-  Prior to the installation of this product, the installation instruction must be read and completely understood. Failure to do so may result in personal injury, property damage or voiding of factory warranty.
 -  Do not install on a structure that is prone to vibration, movement or chance of impact. Reinforce the structure as required before installation. Don't use the product on particle board.
 -  The desk clamp can support a maximum thickness of 9 cm. Confirm the desk edge before installation.
 -  Pay attention to the weight capacity of the mount. Exceeding the limitation can result in function unworkable or even serious personal injury and property damage.
 -  Never operate the mount if parts are missing or damaged. Contact your local service center for warranty service.

PRODUCT LINE GRAPH

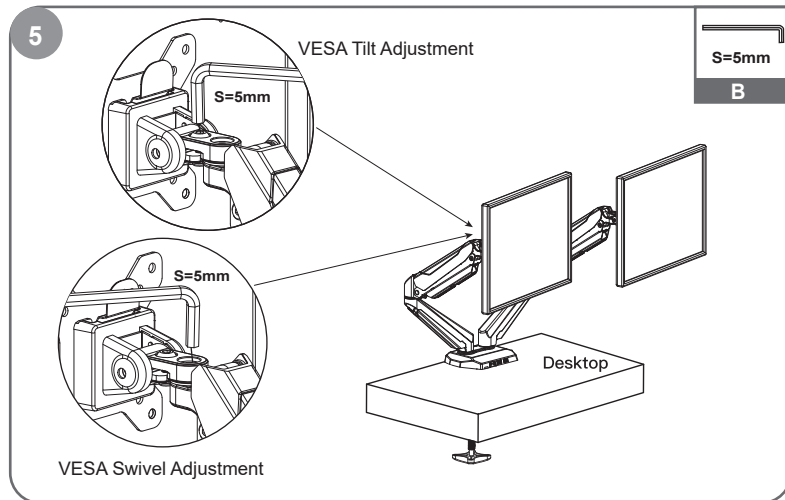
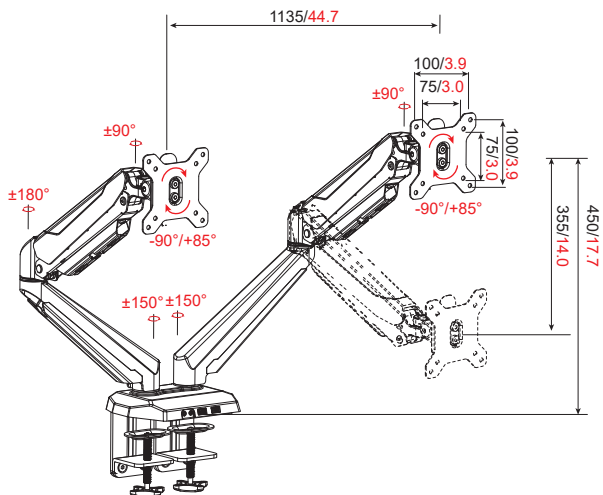

Tighten the bolt with the Allen Key to make the tilt and swivel adjustment.

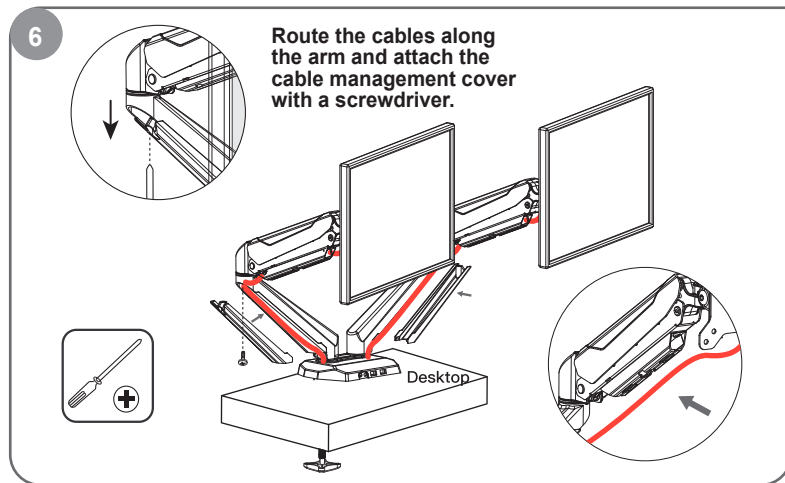

Remove cable covers on the extension arm using a screwdriver.

TOOLS REQUIRED NOT INCLUDED



PARTS INCLUDED

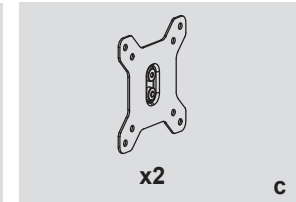
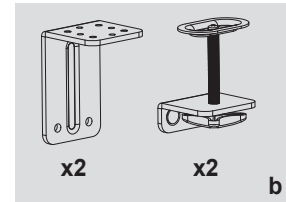
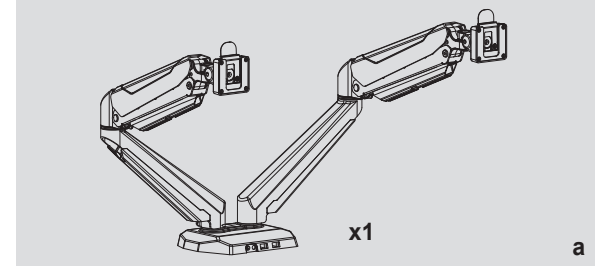

A	M4x12 (x8)	M4x25 (x8)	M4x30 (x8)
B	12X5.8X16 (x8)	S=5mm (x1)	
C	M6x12 (x8)	M8x12 (x4)	S=4mm (x1)
D	(x2)		

3

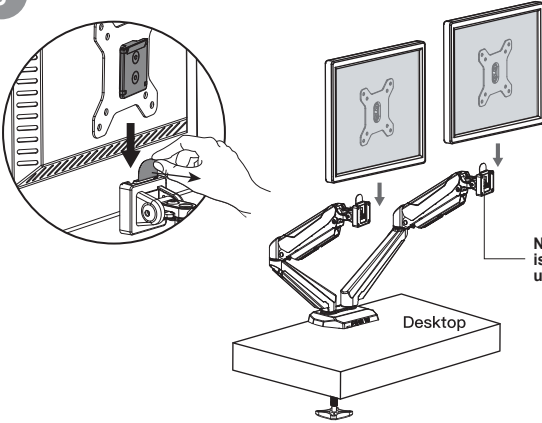

NOTE: If the position is not upright, turn to upright position.

Lift the VESA plate along with monitor and put it on head slot.

4

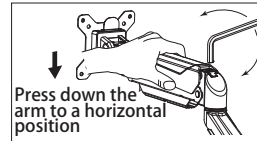

Press down the arm to a horizontal position



Be sure to keep the arm in horizontal position during adjustment. Or else, it would be difficult to adjust the mount.

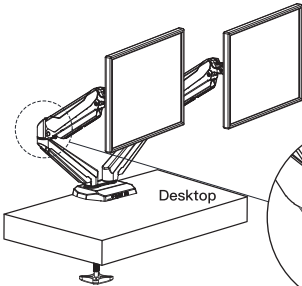

S=5mm



1 turn \approx 1 lbs \approx 0.4kg

NOTE: Turn clockwise to reduce tension for lighter monitors and counter-clockwise to increase tension for heavier monitors.

Use a hex wrench to adjust the height tension of the gas spring arm, to keep different weight of monitors still at any position.

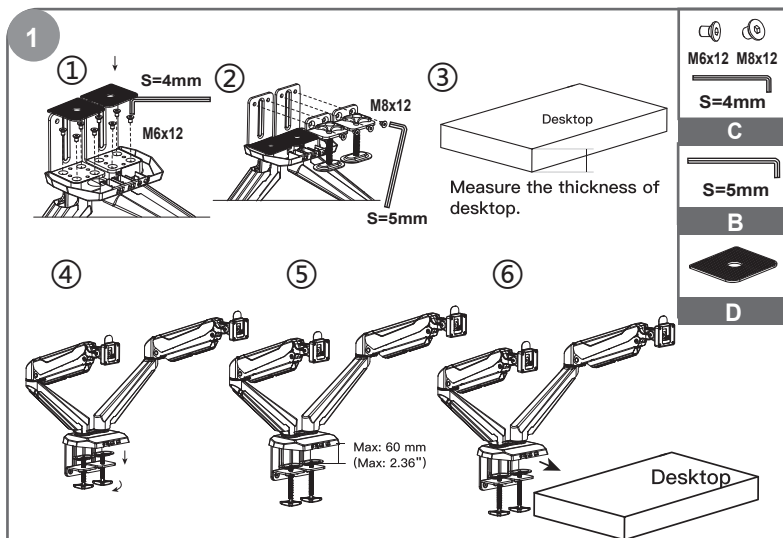

For desk thickness more than 2.36"(60mm) but within 3.35"(85mm), remove clamp screw and attachment entirely and reattach clamp screw with bottom plate upside-down.

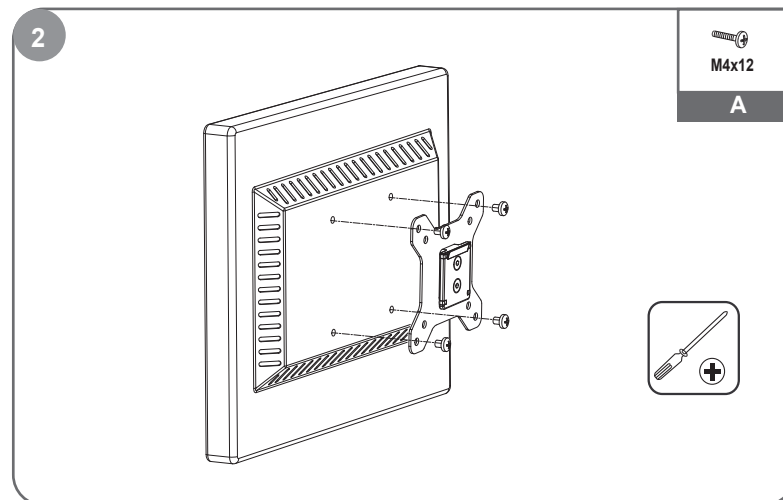
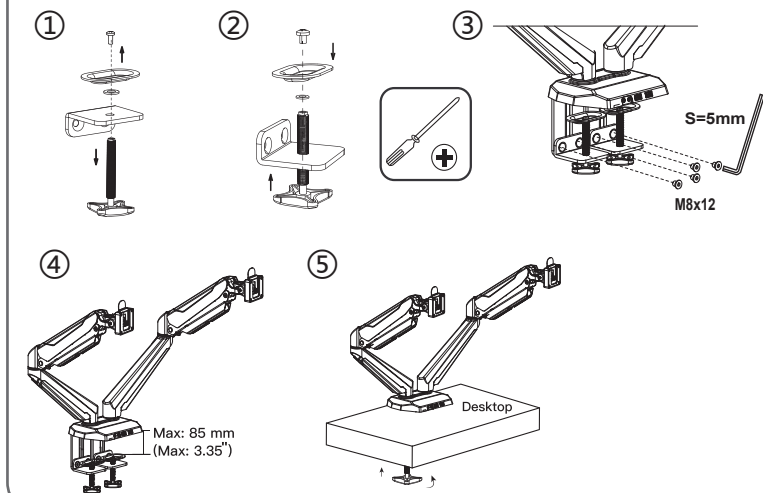

Flush surface installation: Install 4 screws through faceplate to monitor via mounting holes.

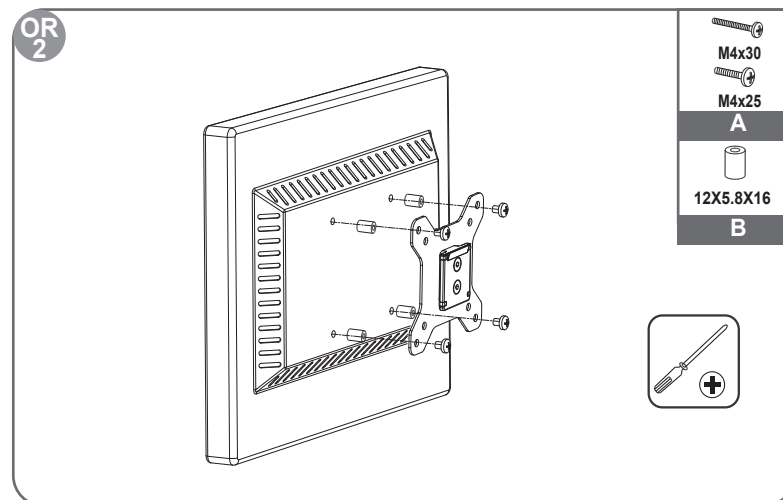

Recessed surface installation: Put 4 spacers between faceplate and monitor. Install 4 screws through faceplate, spacers to monitor via mounting holes.